

Buffers of AUTAN® as per EN 81

Type A	Type B	Type C	Type D
<p>With round steel plate and central bore. The buffer is fixed by a bolt.</p>	<p>Without steel plate, but with central plastic bush (PA). This execution requires a flat counter part without openings and flanges. There must be a corresponding free space at the counterpressure surface for the central fixation.</p>	<p>With square steel plate and four fixing holes or one central bore. Fixing is possible by means of four or one central bolt.</p>	<p>With foamed-in steel plate (2 mm). The height of the inner fixation is 12 mm less than in type B.</p>

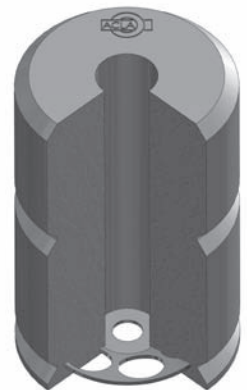
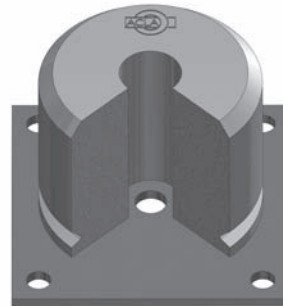

Nominal article sizes (diagrammatic sketches)

Type A	Type B	Type C	Type D

d2 = 4 x 14 up to L = 155
 = 4 x 18 for L = 180 and L = 205
 = 4 x 21 for L = 260

Ø x H	art. no.	type	material	D	D1*	d	d1	H	S	L	L1
80 x 80	300400	A	AUTAN 5	80	110	35	17	80	5		
80 x 80	300410	B	AUTAN 5	80	110	35	17	80	15		
		C	AUTAN 5								
80 x 80	300500	D	AUTAN 5	80	110	35	17	80	2		
80 x 120	300335	A	AUTAN 5	80	110	35	17	120	5		
		B	AUTAN 5								
		C	AUTAN 5								
80 x 120	300518	D	AUTAN 5	80	110	35	17	120	2		
100 x 80	300401	A	AUTAN 5	100	135	35	17	80	5		
100 x 80	300411	B	AUTAN 5	100	135	35	17	80	15		
100 x 80	300421	C	AUTAN 5	100	135	35	18	80	6	130	100
100 x 80	300501	D	AUTAN 5	100	135	35	17	80	2		
100 x 160	300405	A	AUTAN 5	100	135	35	17	160	5		
100 x 160	300415	B	AUTAN 5	100	135	35	17	160	15		
100 x 160	300425	C	AUTAN 5	100	135	35	18	160	6	130	100
100 x 160	300505	D	AUTAN 5	100	135	35	17	160	2		
125 x 80	300402	A	AUTAN 5	125	170	35	17	80	5		
125 x 80	300412	B	AUTAN 5	125	170	35	17	80	15		
125 x 80	300422	C	AUTAN 5	125	170	35	18	80	6	155	125
125 x 80	300502	D	AUTAN 5	125	170	35	17	80	2		
125 x 100	300178	A	AUTAN 5	125	170	35	17	100	5		
125 x 100	300179	B	AUTAN 5	125	170	35	17	100	15		
125 x 100	300117	C	AUTAN 5	125	170	35	18	100	6	155	125
125 x 100	300510	D	AUTAN 5	125	170	35	17	100	2		
125 x 100	300116	A	AUTAN 4	125	170	35	17	100	5		
125 x 100	300376	B	AUTAN 4	125	170	35	17	100	15		
125 x 100	300439	C	AUTAN 4	125	170	35	17	100	6	155	125
125 x 100	300511	D	AUTAN 4	125	170	35	17	100	2		
125 x 100	300450	A	AUTAN 35	125	170	35	17	100	5		
125 x 100	300452	B	AUTAN 35	125	170	35	17	100	15		
		C	AUTAN 35								
125 x 100	300512	D	AUTAN 35	125	170	35	17	100	2		
125 x 160	300406	A	AUTAN 5	125	170	35	17	160	5		
125 x 160	300416	B	AUTAN 5	125	170	35	17	160	15		
125 x 160	300426	C	AUTAN 5	125	170	35	18	160	6	155	125
125 x 160	300506	D	AUTAN 5	125	170	35	17	160	2		
		A	AUTAN 35								
125 x 200	300398	B	AUTAN 35	125	170	35	17	200	15		
125 x 200	300438	C	AUTAN 35	125	170	35	18	200	6	155	125
		D	AUTAN 35						2		
125 x 200	300170	A	AUTAN 45	125	170	35	17	200	5		
125 x 200	300180	B	AUTAN 45	125	170	35	17	200	15		
125 x 200	300440	C	AUTAN 45	125	170	35	18	200	6	155	125
125 x 200	300514	D	AUTAN 45	125	170	35	17	200	2		
125 x 200	300171	A	AUTAN 5	125	170	35	17	200	5		
125 x 200	300181	B	AUTAN 5	125	170	35	17	200	15		
125 x 200	300143	C	AUTAN 5	125	170	35	18	200	6	155	125
125 x 200	300515	D	AUTAN 5	125	170	35	17	200	2		
140 x 100	300183	A	AUTAN 5	140	190	35	17	100	6		
140 x 100	300184	B	AUTAN 5	140	190	35	17	100	15		
140 x 100	300148	C	AUTAN 5	140	190	35	18	100	6	180	140
140 x 100	300513	D	AUTAN 5	140	190	35	17	100	2		
140 x 200	300172	A	AUTAN 5	140	190	35	17	200	6		
140 x 200	300182	B	AUTAN 5	140	190	35	17	200	15		
140 x 200	300144	C	AUTAN 5	140	190	35	18	200	6	180	140
140 x 200	300516	D	AUTAN 5	140	190	35	17	200	2		
140 x 250	300385	A	AUTAN 5	140	190	35	17	250	6		
140 x 250	300330	B	AUTAN 5	140	190	35	17	250	15		
140 x 250	300429	C	AUTAN 5	140	190	35	18	250	6	180	140
140 x 250	300509	D	AUTAN 5	140	190	35	17	250	2		

16

∅ x H	art. no.	type	material	D	D1*	d	d1	H	S	L	L1
165 x 80	300403	A	AUTAN 5	165	225	35	17	80	5		
165 x 80	300413	B	AUTAN 5	165	225	35	17	80	15		
165 x 80	300423	C	AUTAN 5	165	225	35	18	80	6	205	165
165 x 80	300503	D	AUTAN 5	165	225	35	17	80	2		
165 x 160	300407	A	AUTAN 5	165	225	35	17	160	5		
165 x 160	300417	B	AUTAN 5	165	225	35	17	160	15		
165 x 160	300427	C	AUTAN 5	165	225	35	18	160	6	205	165
165 x 160	300507	D	AUTAN 5	165	225	35	17	160	2		
165 x 200	300375	A	AUTAN 5	165	225	35	17	200	5		
165 x 200	300393	B	AUTAN 5	165	225	35	17	200	15		
165 x 200	300147	C	AUTAN 5	165	225	35	18	200	6	205	165
165 x 200	300517	D	AUTAN 5	165	225	35	17	200	2		
220 x 80	300404	A	AUTAN 5	220	300	35	17	80	5		
220 x 80	300414	B	AUTAN 5	220	300	35	17	80	15		
220 x 80	300424	C	AUTAN 5	220	300	35	18	80	6	260	220
220 x 80	300504	D	AUTAN 5	220	300	35	17	80	2		
220 x 160	300408	A	AUTAN 5	220	300	35	17	160	5		
220 x 160	300418	B	AUTAN 5	220	300	35	17	160	15		
220 x 160	300428	C	AUTAN 5	220	300	35	18	160	6	260	220
220 x 160	300508	D	AUTAN 5	220	300	35	17	160	2		

* rounded values

<p>Dimensions in mm. We reserve the right to change sizes. Further dimensions and special types on request.</p>	<p>Our verbal or written recommendations for any application as well as tests are carried out to the best of our knowledge. They are without engagement also as far as patent rights of third parties are concerned, and do not exempt you from checking the products supplied by us to their suitability for the intended procedure and purpose.</p> <p>Application, use and processing of the products are outside our control, and are exclusively the responsibility of the customer. Moreover our general sales conditions apply.</p>	<p>ACLA-WERKE GMBH Frankfurter Straße 142-190 D-51065 Köln</p> <p>Tel. ++49(0)2 21/6 99 98 - 0 Fax ++49(0)2 21/69 71 21</p>
---	--	--